

TAD1 – Aquadisc 1

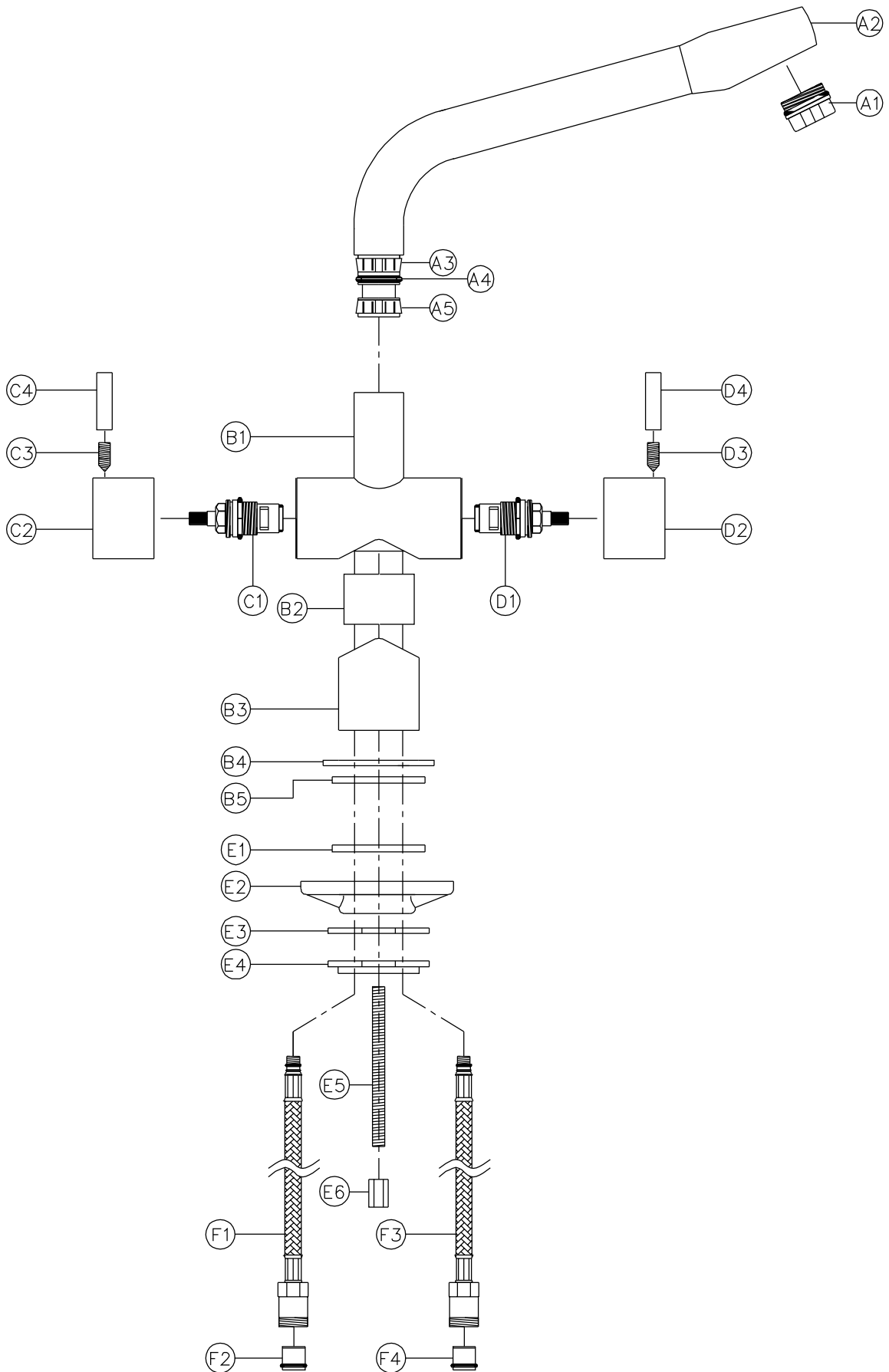

General Advice:

- These instructions are intended as a guide only, if you are in any doubt you should seek the advice of a qualified professional.
- Take care not to mark finished parts with screwdrivers or other tools.
- Use a pair of rubber gloves to get a better grip on decorative hand tight parts.
- Ensure all parts are reassembled tightly.
- After maintenance test that all assemblies are water tight and function correctly.
- Always isolate the hot and cold water supplies before starting any maintenance, once isolated you should drain any residual water from your system.

To replace the valve:

1. Unscrew and remove handle peg (D4).
2. Using a 3mm AF Allen key unscrew handle grub screw (D3)
3. Pull handle body (D2) away from the tap body (B1) to reveal the valve (D1).
4. Unscrew valve (D1) with a 17mm ring spanner.
5. Clean the Inside of chamber (B1) with a soft wet cloth.
6. Reassemble the tap in the reverse order with the new valve.

To replace the spout o-rings:

NOTE: This spout is snap fitting and may require the tap to be removed from the sink/worktop before carrying out the procedure below

1. Whilst holding the tap body (B1) firmly in place remove spout (A2) by pulling it vertically away from the body.
2. Remove and replace snap fit PTFE rings (A3 & A5) with the new ones provided.
3. Remove and replace the old o-ring (A4) with the new one using a small screwdriver or similar.
4. Grease the O-ring (A4) thoroughly with silicone or alternative similar grease.
5. Whilst holding the tap body (B1) firmly in place push spout (A2) back into the tap body (B1). Ensure the spout (A2) has snap fitted into position correctly before the water supply is reconnected.